

THIS DOCUMENT IS THE PROPERTY OF SELECT CONTROLS INCORPORATED AND IS CONVEYED WITH THE EXPRESS CONDITION THAT IT AND THE INFORMATION CONTAINED IN IT ARE NOT TO BE USED, DISCLOSED, OR REPRODUCED IN WHOLE OR IN PART, FOR ANY PURPOSE WITHOUT THE EXPRESS WRITTEN CONSENT OF SELECT CONTROLS INCORPORATED; AND THAT NO RIGHT IS GRANTED TO DISCLOSE OR SO USE ANY INFORMATION CONTAINED IN SAID DOCUMENT.

NOTES:

1. SWITCH: PLANAR TILT, OMNIDIRECTIONAL, NORMALLY CLOSED, AUTOMATICALLY RESETTABLE
2. WEIGHT: 5 GRAMS MAXIMUM
3. CONTACTS: SPST, NORMALLY CLOSED
4. CONTACT RESISTANCE: 50 OHMS MAXIMUM
5. CONTACT RATING: 250 MA AT 24 VDC
6. INSULATION RESISTANCE: 30 MEGOHMS MINIMUM AT 500 VDC
7. OPERATING CHARACTERISTICS:
 - a) MUST OPEN WHEN TILTED PAST 25° +/-4° FROM VERTICAL POSITION
 - b) MUST RE-CLOSE WHEN RETURNED TO WITHIN 10° FROM VERTICAL POSITION
8. OPERATING TEMPERATURE RANGE: -65 DEGREES F TO +275 DEGREES F
9. SWITCH SEAL: HERMETIC
10. LEAD STRENGTH: 3 LBS. MINIMUM AXIAL PULL
11. OPERATIONAL LIFE: 1,000,000 CYCLES

5002-3-000

G

REVISIONS				
ALT	DESCRIPTION	BY	CHK	ENG
*	ECN'S A THRU F SEE SECTION 3	BJE		
G	SEE ECN 5003-000 G	BJE		

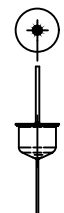

ACTUAL SIZE

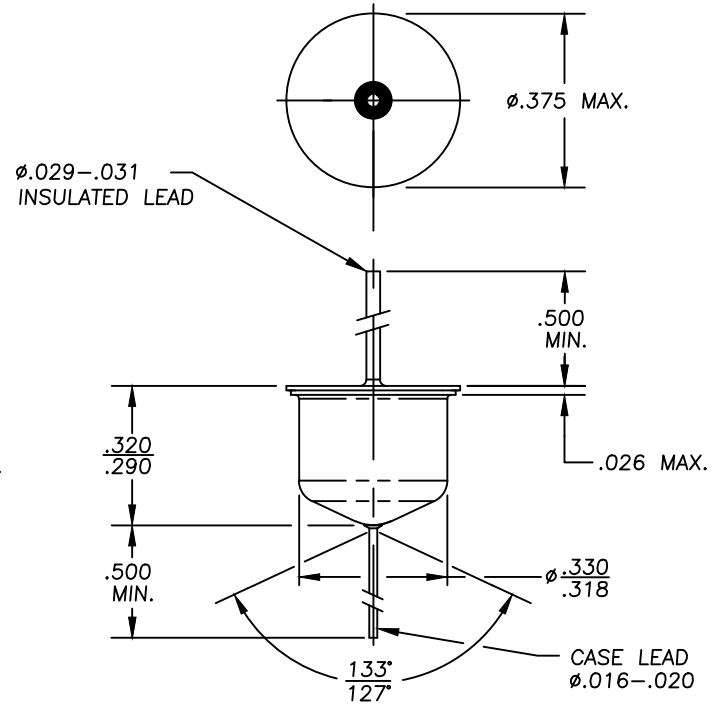

MATERIAL	_____
FINISH	_____
<small>DO NOT SCALE DRAWING REMOVE BURRS, BREAK SHARP EDGES. TOLERANCE UNLESS SPECIFIED: FRACT: ± 1/64 ANGLE: ± 0°30" MACH FINISH: 125 DEC: .00 ± .010 RMS DEC: .000 ± .005</small>	

ITEM NO.	NO. REQ'D	PART NO.	DESCRIPTION	REMARKS
BILL OF MATERIAL				
TITLE TILT SWITCH, 25° NORMALLY CLOSED			45-3 KNICKERBOCKER AVE. BOHEMIA, N.Y. 11716	
NO. REQ'D	N/A	NO. REQ'D	N/A	SCALE: 4:1, 1:1
				WEIGHT: NOTED
				<small>DRAWN: AHN</small> <small>CHECKED:</small> <small>ENGINEER:</small> <small>APPROVED:</small> <small>APPROVED:</small>
			DATE: 1/26/02	DRAWING NO. 5002-3-000
			SHEET 1 OF 1	REV G